

PROPOSED THIRD FLOOR PLAN
Scale: 3/32" = 1'-0"

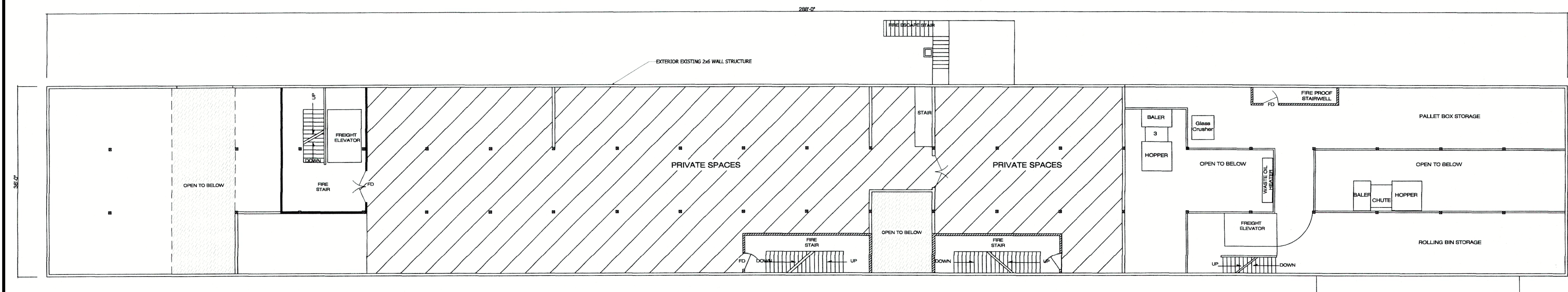

PROPOSED SECOND FLOOR PLAN
Scale: 3/32" = 1'-0"

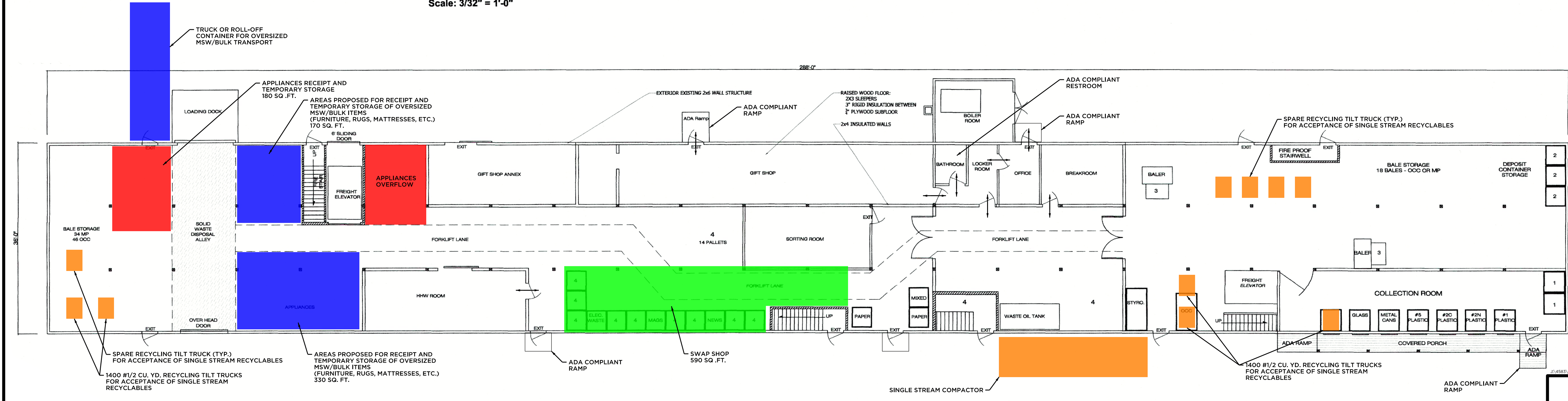

PROPOSED FIRST FLOOR PLAN
Scale: 3/32" = 1'-0"

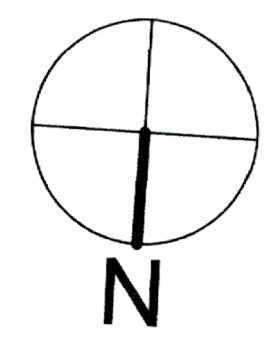

Note: Barn provides approx 14,060 sq ft of floor space

- KEY:**
1. DEPOSIT CONTAINERS COLLECTION
 2. METAL CONTAINERS STORAGE
 3. CULLING TABLES
 4. PALLET STORAGE (48 UNITS)
- FD = FIREDOOR
OCC = CORRUGATED CARDBOARD
MP = MIXED PAPER
C = CANS
P = PLASTIC

ACCESS TO BE ADA COMPLIANT

Barton & Loguidice
Civil Engineering • Environmental Consulting • Land Surveying • Construction Management

41 Sequin Drive
Glastonbury, CT 06033
Phone: (860) 633-5770
Fax: (860) 633-5971
www.bartlog.com

PROJ. ENGINEER: MJP
PROJ. MANAGER: MMZ
OFFICE REVIEW: KRG

PREPARED FOR:
THE TOWN OF BOWDOINHAM

RECYCLING BARN REHABILITATION
PRELIMINARY FLOOR PLAN

243 POST ROAD, BOWDOINHAM, CT

REVISIONS	DATE	BY
09/21/23		

PROJECT: 4583.001	DATE: 09/21/23
SCALE: AS NOTED	SHEET NO. 1 OF 1