

# WATERFRONT PERMITTING PHASE II

- Design & Layout





EXISTING GRAVEL ACCESS DRIVE

EXISTING RAILROAD TRACKS

River Road

- 1 CROSSWALK TO MAILLY PARK
  - 2 EXISTING RENTAL WITH IMPROVED PARKING
  - 3 OPEN SPACE FLEXIBLE PARKING
  - 4 PARKING
  - 5 BIO-RETENTION & RAIN GARDENS
  - 6 40 X 80 PAVILION
  - 7 NATURE PLAY
  - 8 ACTIVE RECREATION AREAS & COURTYARD
  - 9 PICNIC AREA & SUCCESSIONAL MEADOW
  - 10 VEHICULAR GATE & TRAIL HEAD
  - 11 HAND CARRY BOAT LAUNCH
  - 12 OPEN SPACE/LAWN
  - 13 (5) OVERFLOW LARGE TRAILER PARKING (MAILLY PARK)
  - 14 CONNECTION TO MERRYMEETING TRAIL
  - \* BATHROOM LOCATION
- 
-  10 X 10 FARMERS MARKET TENTS
  -  VEGETATED EARTHEN BERMS & SEATING
  -  SEATING

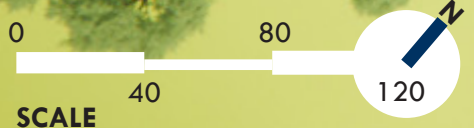



Vegetation restoration & screening

EXISTING RAILROAD TRACKS TO REMAIN

Previously permitted shoreline area (PHASE I)



- HAND CARRY BOAT LAUNCH**  
(previously permitted)
- EARTHEN BERMS WITH MEADOW PLANTINGS**  
(NO MOW)
- RESTROOMS**
- 40X80' PAVILION**
- FLEXIBLE ACTIVE RECREATION AREA**
- NATIVE MEADOW SLOPE PLANTING**
- HAND CARRY TRAILER PARKING (2) & DESIGNATED TURNAROUND SPACE (1)**
- NATURE PLAY**
- ACTIVE RECREATION AREA**
  - \* Basketball Court (multi-court) & Pickleball
  - \* Bocce Ball
  - \* Outdoor Fitness Equipment
  - \* Bike Racks
- PICNIC AREA & NATIVE MEADOW**  
(Restoration Area)
- TRAILHEAD**

Path to Pavilion looking Southwest



2'-5' BERMS W/ NATIVE  
NO MOW PLANTINGS

RAIN GARDEN

LAWN

2'-5' BERMS W/ NATIVE  
NO MOW PLANTINGS

4' WIDE STONE DUST PATH

MOWN SHOULDERS

MOWN SHOULDERS

Path to Pavilion looking West



1:30 PM



6:45 AM

Birds Eye Perspective Looking North



TOWN HALL



DOWNTOWN



MALLY PARK



Path to Natural Play Area looking West





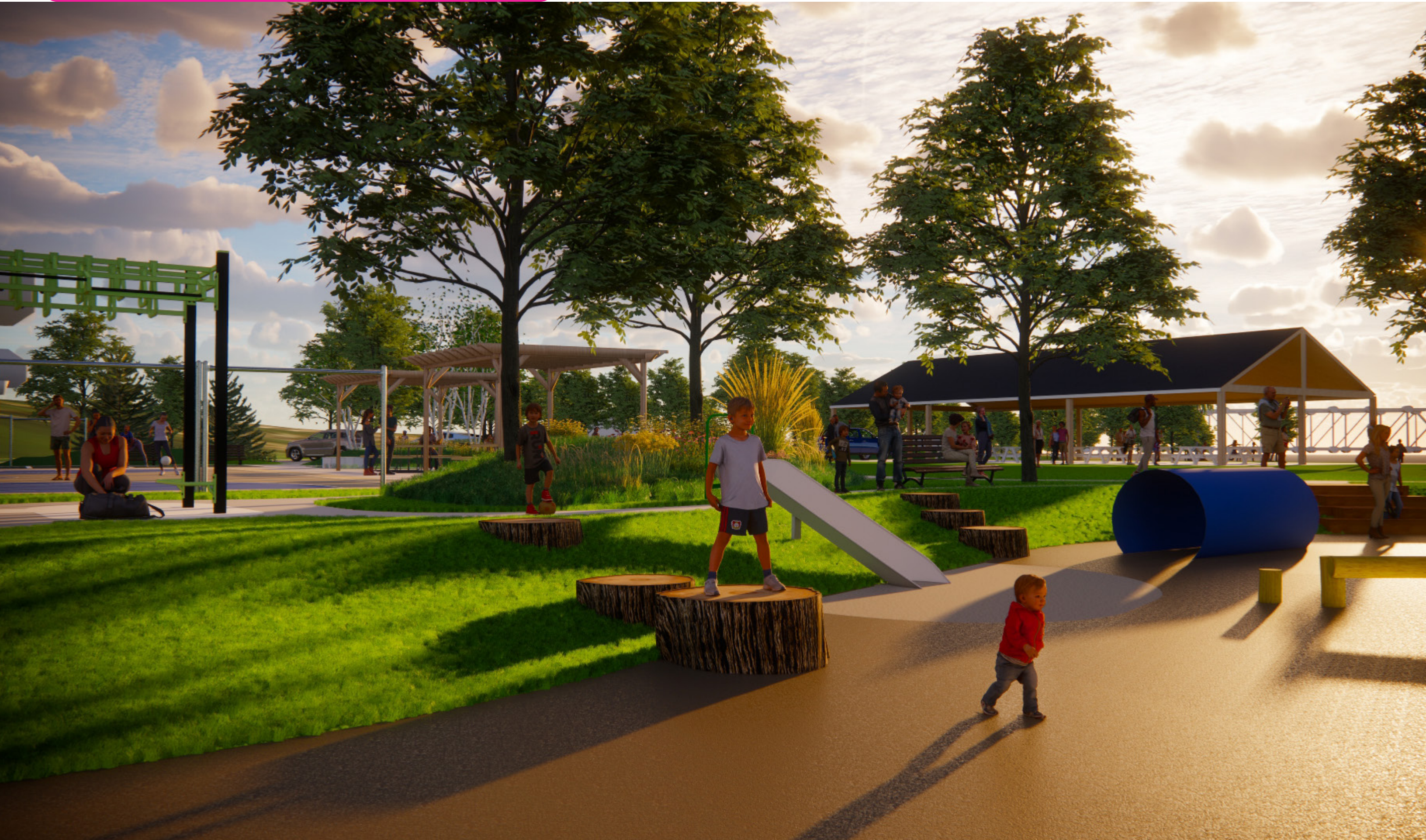

View East from Bocce Court

7:00 PM



View South from Active Recreation area

