



STATE OF MAINE
DEPARTMENT OF AGRICULTURE, CONSERVATION & FORESTRY
BUREAU OF PARKS & LANDS
22 STATE HOUSE STATION
AUGUSTA, MAINE 04333

JANET T. MILLS
GOVERNOR

AMANDA E. BEAL
COMMISSIONER

June 1, 2026

TOWN OF BOWDOINHAM
PO BOX 85
BOWDOINHAM ME 04008

RE: Submerged Lands Lease #02-26L, Bowdoinham

Dear Town Manager:

On 1/30/1997, the Bureau of Public Lands issued a 30-year lease (or amended lease) to you, or a previous owner, for the following: BOAT RAMP AND FLOAT SYSTEM in Bowdoinham. This lease gives you exclusive rights to use publicly-owned submerged land, which is the land below or beyond the **mean low-water mark**, for your structure. The lease expires on 12/31/2026 and will need to be renewed for a new 30-year term. Although the lease does not expire for several months, we are sending this notice now so that the requested photograph may be taken when any seasonal components, such as floats, are in the water.

Enclosed is a Submerged Lands Application to obtain a new lease for your structure. I have also included a location map and copy of the site plan that was submitted with the original application. You may use this plan if no changes have been made. If the site plan is no longer accurate, however, please provide a new one or show the changes on the enclosed plan. Where available, a copy of the tax map has also been included with the application package. Once we receive the completed application, the Bureau will review it for consistency with the Submerged Lands Act and Rules. Under the Bureau's review procedures for existing structures, the municipal officials and public are provided an opportunity to comment on issues regarding public trust rights such as navigation, fishing or other marine uses of the area, or ingress and egress of riparian owners.

A \$100.00 administrative fee is due to cover processing of the application. Please make check payable to: *Treasurer, State of Maine* and include it with your application. We request that the application be submitted by **August 30, 2026**. A new conveyance would begin on January 1, 2027.

If you have any questions, information about the Submerged Lands Program is available on the Bureau's website at www.maine.gov/dacf/publiclands. Please feel free to contact me at (207) 287-4970 or via email at: Anja.Parlin@maine.gov. Thank you.

Sincerely,

Anja Parlin
Submerged Lands Program

Enc: application, location map, tax map (if available) and site plan(s)

ANDREW R. CUTKO, DIRECTOR
BUREAU OF PARKS & LANDS
18 ELKINS LANE, HARLOW BUILDING



PHONE: (207) 287-3821
FAX: (207) 287-6170
WWW.MAINE.GOV/DACF/

Application No. SL _____

Lease/Easement No. _____



**Department of Agriculture, Conservation & Forestry
Bureau of Parks and Lands
22 State House Station
Augusta, Maine 04333
(207) 287-3821**

**APPLICATION FOR SUBMERGED LANDS LEASE OR EASEMENT
PURSUANT TO TITLE 12 M.R.S.A. SECTION 1801 & 1862
*RENEWAL APPLICATION WITH SITE PLAN***

PLEASE TYPE OR PRINT:

1) Applicant Information:

A. Name of Applicant: _____

B. Address: _____ Tel. No.: _____

C. City: _____ State: _____ Zip: _____

D. Email Address: _____

E. Local Contact or Agent (Name, Address, Tel. No.): _____

2) General Information:

A. Name of Tidal Waters, Pond, Lake, River: _____

B. Nearest Road, Street, or Route No.: _____

C. City/Town: _____ County: _____

D. Directions To The Site: _____

4) Project Information

A. Describe the present use of the structure (for example: residential, commercial, public, etc.): If commercial, describe the type of business. *Note:* "Structure" includes any seasonal floats.

B. Is the structure used exclusively for commercial fishing? _____ yes _____ no

C. List any portion of the structure(s) that is in place seasonally (less than 7 months of the year):

D. Are slips rented or otherwise made available for private use for a fee? _____ yes _____ no

E. How far beyond the mean (average) low-water line does the structure extend? _____ feet

F. What is the estimated distance between your structure and the next nearest structure that extends into the water? _____ feet

5) Lot Information:

A. Do you: own _____ lease _____ have an easement _____ or option _____ on the shorefront property?
Other (please describe) _____

List the municipal tax map numbers: Map # _____ Lot # _____ List the acreage of the lot _____

B. What is the length of your shore frontage? Frontage is measured in a straight line between side lot lines where those lines meet the shore. _____ feet

C. Is there a customary or traditional public access way located on the property or in the project vicinity? If so, describe:

D. Describe the use of abutting properties (residential, commercial fishing, boatyard, etc.).

I authorize staff from the Departments of Agriculture, Conservation & Forestry, Marine Resources and Inland Fisheries and Wildlife to access the site in conjunction with this application and for the purpose of determining compliance with the Submerged Lands Rules.

By signing below, as the applicant (or authorized agent), you certify that the information contained in this application and attached drawings is complete and accurate to the best of your knowledge.

DATE: _____

SIGNATURE OF APPLICANT

If signature is other than applicant, attach letter of agent authorization signed by applicant.

PRINT NAME AND TITLE

ATTACHMENT A

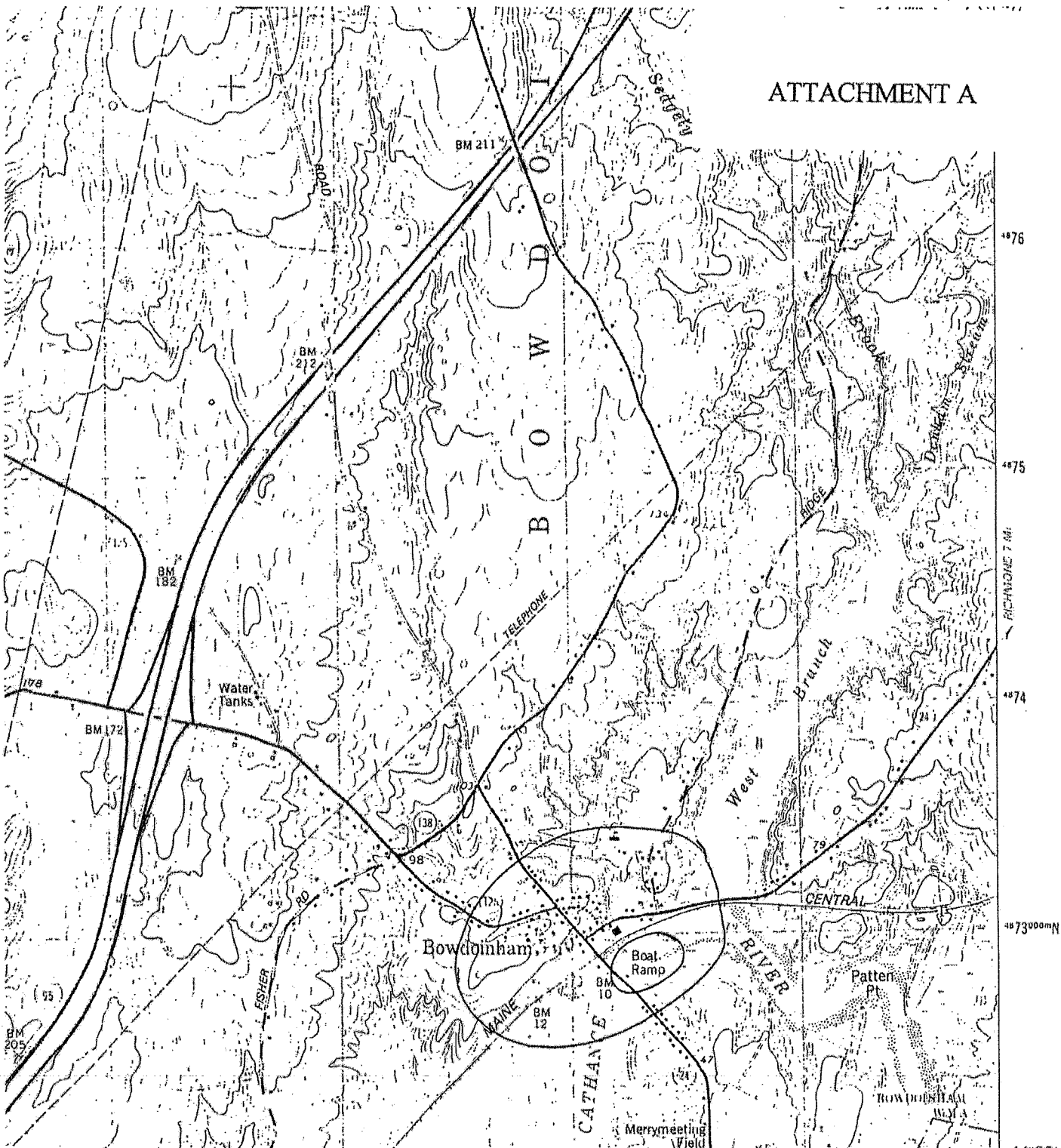

MAINE 1:50,000 0 31 MI
 26 55 27
 4280020E
 HIRSHWICK 7 MI
 69°52'30"
 44°00'
 RICHMOND 7 MI
 4876
 4875
 4874
 4873
 4872
 4871
 4870
 4869
 4868
 4867
 4866
 4865
 4864
 4863
 4862
 4861
 4860
 4859
 4858
 4857
 4856
 4855
 4854
 4853
 4852
 4851
 4850
 4849
 4848
 4847
 4846
 4845
 4844
 4843
 4842
 4841
 4840
 4839
 4838
 4837
 4836
 4835
 4834
 4833
 4832
 4831
 4830
 4829
 4828
 4827
 4826
 4825
 4824
 4823
 4822
 4821
 4820
 4819
 4818
 4817
 4816
 4815
 4814
 4813
 4812
 4811
 4810
 4809
 4808
 4807
 4806
 4805
 4804
 4803
 4802
 4801
 4800

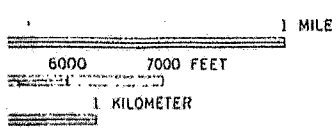

LOW WATER
 TIDE
 HIGH WATER

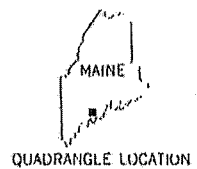

ROAD CLASSIFICATION

Primary highway, hard surface	Light-duty road, hard or improved surface
Secondary highway, hard surface	Unimproved road
Interstate Route	U. S. Route
	State Route

ANDRUS
 .ORADO 80225

BOWDOINHAM, MAINE
 SW/4 GARDNER 15' QUADRANGLE
 44069-AB-TF-024

AVAILABLE ON REQUEST

1980
 DMA 7072 III SW SERIES V811

U-3



ATTACHMENT B

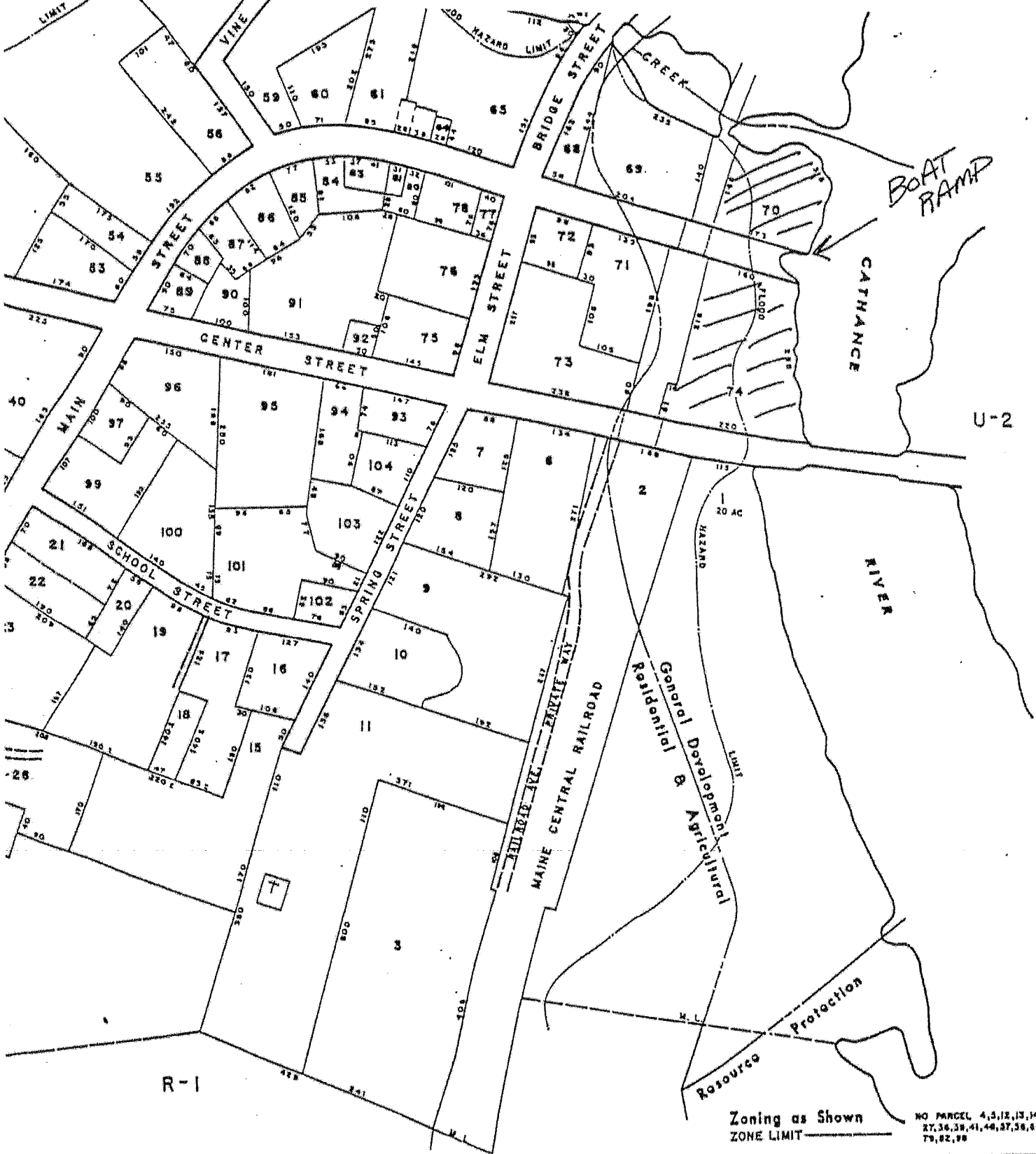

U-2

R-1

Zoning as Shown
ZONE LIMIT

NO PARCEL 4, 5, 12, 13, 14, 24,
27, 36, 38, 41, 44, 57, 58, 62, 63,
79, 82, 88

PROPERTY MAP BOWDOINHAM, MAINE

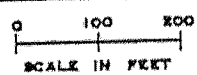

U-1

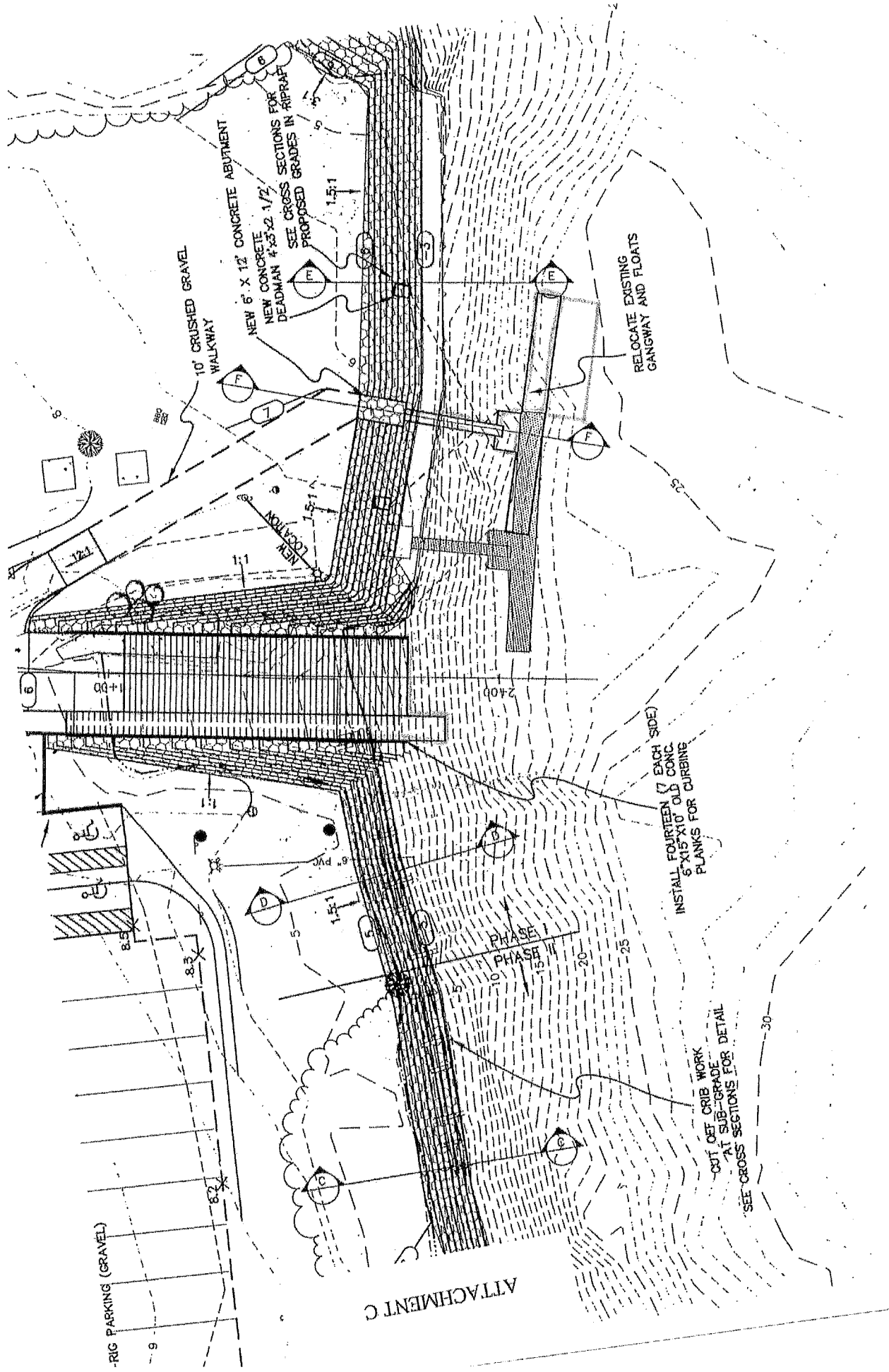

RIG PARKING (GRAVEL)

9

8.2

8.3

12.4

6

1+00

2+00

10'

7

7

7

7

7

7

7

7

7

7

7

7

7

7

7

7

1.5:1

1.5:1

1.5:1

1.5:1

1.5:1

1.5:1

1.5:1

1.5:1

1.5:1

1.5:1

1.5:1

1.5:1

1.5:1

1.5:1

1.5:1

1.5:1

1.5:1

1.5:1

1.5:1

1.5:1

1.5:1

1.5:1

1.5:1

1.5:1

1.5:1

1.5:1

1.5:1

1.5:1

1.5:1

1.5:1

1.5:1

1.5:1

1.5:1

1.5:1

5

5

5

5

5

5

5

5

5

5

5

5

5

5

5

5

5

10

10

10

10

10

10

10

10

10

10

10

10

10

10

10

10

10

15

15

15

15

15

15

15

15

15

15

15

15

15

15

15

15

15

20

20

20

20

20

20

20

20

20

20

20

20

20

20

20

20

20

25

25

25

25

25

25

25

25

25

25

25

25

25

25

25

25

25

30

30

30

30

30

30

30

30

30

30

30

30

30

30

30

30

30

35

35

35

35

35

35

35

35

35

35

35

35

35

35

35

35

35

40

40

40

40

40

40

40

40

40

40

40

40

40

40

40

40

40

45

45

45

45

45

45

45

45

45

45

45

45

45

45

45

45

45

50

50

50

50

50

50

50

50

50

50

50

50

50

50

50

50

50

55

55

55

55

55

55

55

55

55

55

55

55

55

55

55

55

55

60

60

60

60

60

60

60

60

60

60

60

60

60

60

60

60

60

65

65

65

65

65

65

65

65

65

65

65

65

65

65

65

65

65

70

70

70

70

70

70

70

70

70

70

70

70

70

70

70

70

70

75

75

75

75

75

75

75

75

75

75

75

75

75

75

75